



6 Gold-plated silver terrine with the coat of arms of Elector Max Emanuel, Paris, 1714/15

7 Commode 'with nymphs', Charles Cressent, Paris, c. 1730/1735



8 Writing utensils of Madame Pompadour, Sèvres porcelain manufactory, 1760/61



9 Nymphenburg Palace, painting by Bernardo Bellotto, also called Canaletto, 1761



10 Crown of the kingdom of Bavaria, Martin Guillaume Biennais, Paris, 1806

UPPER FLOOR

Residence Museum/Upper floor

- 12/13 Stairs to Black Hall/Black Hall ■
- 14-14a Yellow Staircase and Room 14a closed for construction works ■
- 14b-c 'Schlachtsäle' (Battle Halls) ■
- 14d-h Eighteenth- and nineteenth-century dining culture ■
- 15-21 East Asian Porcelain ■
- 22-31 Electoral Apartments ■
- 32 All Saints' Corridor ■
- 33-41 So-called Court Garden Rooms and Charlotte Chambers ■
- 42-45 Charlotte Corridor and Broad Staircase ■
- 46-53 'Trierzimmer' (Trier Rooms) ■
- 54 Hall of the Knights of St George/Conservatory exhibition ■
- 55-62 Ornate Rooms with Green Gallery ■
- 63-66 Rear chambers of the Ornate Rooms ■
- 67-69 Papal Rooms ■
- 70-71 Golden Hall ■
- 72 Queen Mother Staircase ■
- 94 Chapel Staircase ■
- 95 Reliquaries Room ■
- 96/89 Gallery of the Court Chapel ■
- 97-98 Vestibule and Ornate Chapel ■
- 99 Antler Corridor ■
- 100-102 Former chambers of the Council of State ■
- 103 'Hartschiersaal' (Bodyguards' Hall) ■
- 104-109 Steinzimmer (Stone Rooms) ■
- 110-112 Four White Horses Hall, Imperial Hall, Imperial Staircase ■
- 113-114 Theatiner Corridor ■
- 115-127 Apartments of the 'Königsbau' (King's Tract) ■
- 116a-d Silver collection ■
- 128-129 Collection of miniatures ■

- Accessible museum rooms
- Collection areas
- Closed for construction works
- Rooms that are not part of the museum
- ▼ Access and Exit Königsbau 'Königsbau' (King's Tract)
- WC / Aufzug

Bayerische Verwaltung der staatlichen Schlösser, Gärten und Seen
 Postfach 20 20 63 · 80020 München
 info@bsv.bayern.de · www.schloesser.bayern.de
 #schloesserbayern.de · schloesserblog.bayern.de



Selected rooms on the upper floor



● 'Königsbau' (King's Tract)

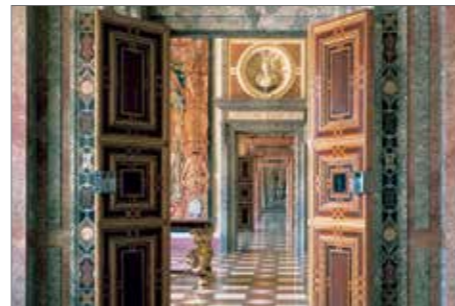

● Steinzimmer (Stone Rooms)



● Ornate Rooms



● Green Gallery

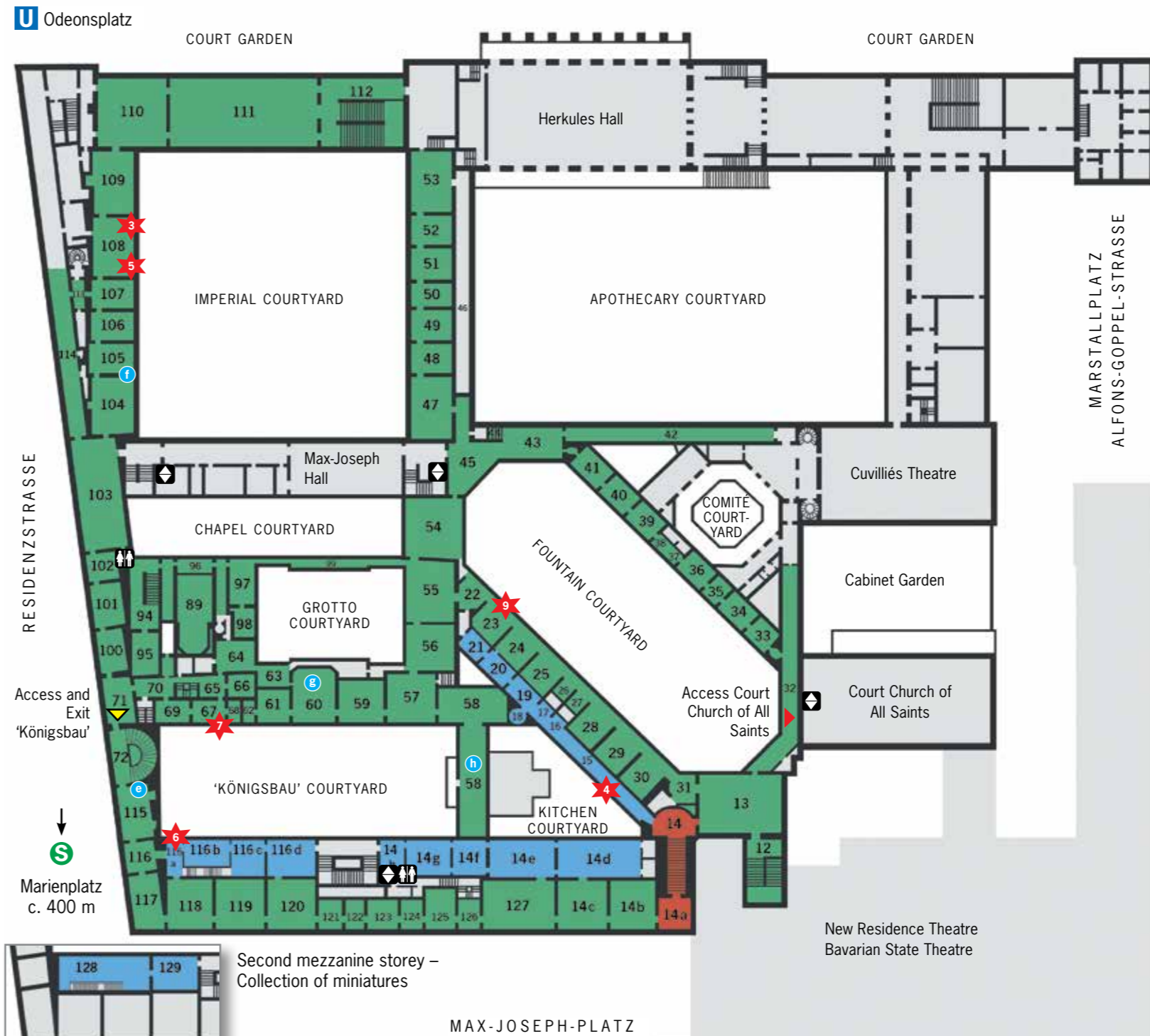

06/2018

Munich Residence

RESIDENCE MUSEUM
 TREASURY
 CUVILLIÉS THEATRE



Bayerische Schlösserverwaltung





I wish you a fascinating visit to Munich Residence!

Albert Füracker, MdL

Bavarian Minister of State of Finance, Regional Development and Regional Identity

Munich Residence

Residence Museum/Treasury/Cuvilliés Theatre

For centuries the Munich Residence was the political and cultural centre of first the dukes, then the electors (from 1623) and finally the kings of Bavaria (1806–1918). As the residence and seat of government of the Wittelsbachs, the history of this palace is inseparable from that of Bavaria's ruling dynasty. The various rulers furnished and extended the rooms to suit their own personal tastes, engaging important artists for the purpose. The Residence was also the place where rulers kept their art collections and treasure.

Opening times of the Residence Museum and Treasury

April–14 Oct.: 9am–6pm
15 Oct.–April: 10am–5pm
Last admissions 5pm or 4pm

♿ Museum rooms only accessible via a number of steps or a staircase

A free audio guide (German, English, French, Italian, Spanish and Russian) to the Residence Museum and the Treasury can be obtained at the entrance.

Certain rooms may be inaccessible to the public at short notice when an event is being held in the Residence.

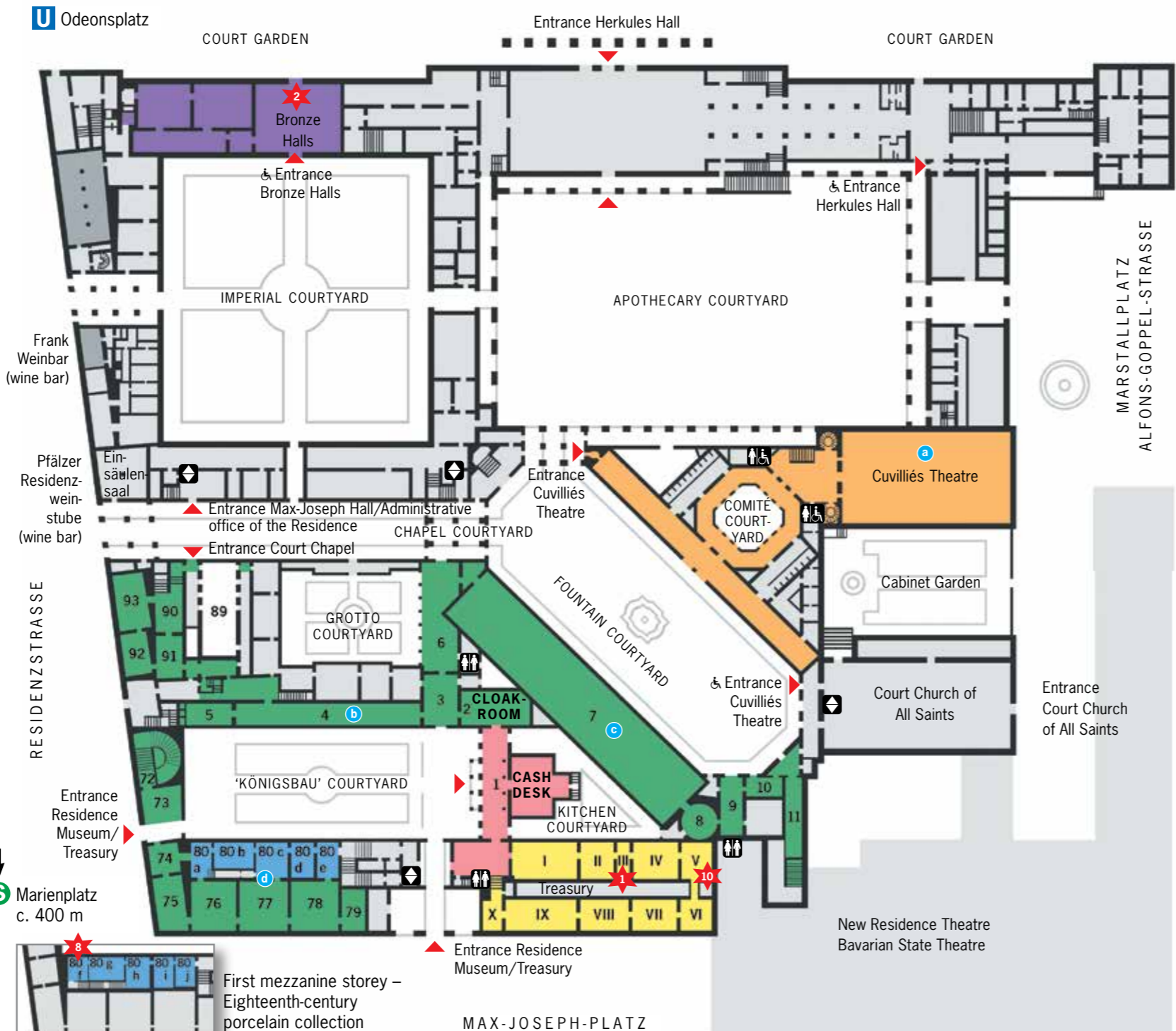

Selected rooms on the ground floor



a Cuvilliés Theatre



b Ancestral Gallery

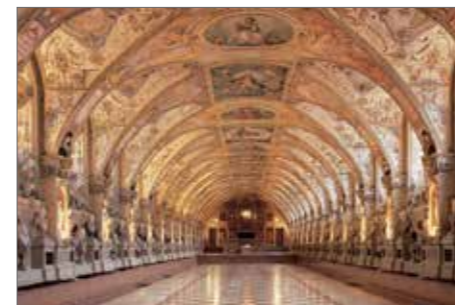

c Antiquarium



d Nibelungen Halls

Opening times of the Cuvilliés Theatre

24 March–28 July: Mon.–Sat.: 2pm–6pm
Sun./public holidays: 9am–6pm
29 July–10 Sept.: daily 9am–6pm
11 Sept.–14 Oct.: Mon.–Sat.: 2pm–6pm
Sun./public holidays: 9am–6pm
15 Oct.–31 March: Mon.–Sat.: 2pm–5pm
Sun./public holidays: 10am–5pm
Last entrance: 5 respectively 4pm

♿ Access via ramp, toilet for the disabled available

Residence Museum/Ground floor

- 1 Vestibule – entrance area
- 2–3 Garden Halls – cloakroom
- 4–5 Ancestral Gallery and Porcelain Cabinet
- 6 Grotto Courtyard
- 7 Antiquarium
- 8–11 Octagon and stairs to Black Hall
- 75–79 Nibelungen Halls in the 'Königsbau' (King's Tract)
- 80a–e Nineteenth-century porcelain collection
- 80f–j Eighteenth-century porcelain collection
- 89 Court Chapel accessible via the gallery
- 90 Chapel Staircase
- 91–93 Sacred Vestments Rooms

Treasury

I–X Goldsmith's work spanning several centuries from the Middle Ages to the neoclassical era

Cuvilliés-Theatre

Created by the architect François Cuvilliés the Elder and Munich court artists from 1751 to 1755, this court theatre is a masterpiece of rococo art

- Entrance, cash desk, museum shop
- Accessible museum rooms
- Treasury
- Cuvilliés Theatre
- Bronze halls
- Collection areas
- Rooms that are not part of the museum
- Entrances
- WC / Lift

Information:

Verwaltung der Residenz München
Residenzstraße 1 · 80333 München
Tel. + 49 89 29067-1 · Fax +49 89 29067-225
www.residenz-muenchen-blog.de · www.residenz-muenchen.de

HIGHLIGHTS

1 St George's reliquary, Munich goldsmith work, between 1586 and 1597



2 Bronze sculpture of the Tellus Bavarica, Hubert Gerhard, Munich, before 1589



3 Tapestry showing the deeds of Otto von Wittelsbach, Hans van der Biest from a design by Peter Candid, 1604/1611



4 Candlestick in the form of foo dogs made of Japanese porcelain, c. 1670 to 1690



5 Augsburg silver clock, Johann Andreas Thelott et al., c.1690/1698

