



*I wish you a fascinating visit to the palace complex in Schleissheim!*

**Dr. Markus Söder, MdL**

*Bavarian Minister of State of Finance, Regional Development and Regional Identity*



*Schleissheim New Palace*

## Schleissheim New Palace

The palace complex of Schleissheim is among the largest and most impressive of the Wittelsbach dynasty's residences in Bavaria. The Old Palace originated in the early seventeenth century as a ducal country mansion. The Baroque palace buildings, the monumental New Palace and the hunting lodge of Lustheim were built by Elector Max Emanuel (r. 1680–1726). They enclose one of Europe's most important Baroque gardens with a canal system, which the Elector had laid out by French landscape gardeners.

At the height of his career in the 1690s, Max Emanuel and his court architect, Henrico Zuccalli, began planning the construction of a new, extremely ambitious residential palace in Schleissheim. As an extensive four-winged complex, it was intended to incorporate the Old Palace built by his ancestors. However, following military defeats and a period of exile in France in 1704–1715, Max Emanuel had to make do with constructing the single-winged New Palace. Despite this, one of the most

*Vestibule with trompe-l'œil painting (left); Great Gallery with paintings from the State gallery (right)*



*Great Hall with ceiling fresco, Jacopo Amigoni, 1722 (left); state bedroom in the Elector's suite (right)*



*Schleissheim Old Palace*

## Schleissheim Old Palace

The Old Palace is the original germ of the extensive palace complex in Schleissheim. Duke Wilhelm V of Bavaria (r. 1579–1598) purchased several farm properties starting in 1595, including nine hermitages and chapels, and extended them from 1598 to 1600 by adding a modest manor house. Starting in 1617, Duke Maximilian I (r. 1598–1651) replaced his father's hermitage with an ambitious new building modelled on the modern Upper Italian villa architecture of the late Renaissance.

During the Second World War, the Old Palace with its splendid interior decoration was severely damaged. Rebuilt in 1971–1972, it now hosts two branches of the Bavarian National Museum: a folklore collection including over 6000 items established by Gertrud Weinhold, illustrating ethnic religious celebrations and everyday culture from all over the world, entitled 'The Religious Year and Its Festivals'; and an exhibition on the regional culture of East and West Prussia.

*Old and New Palace of Schleissheim, engraving after Mathias Disel, c. 1722*



*Lustheim Palace*

## Lustheim Palace

Elector Max Emanuel had the hunting lodge of Lustheim built between 1684 and 1688, to celebrate his wedding to the Emperor's daughter Maria Antonia. Since the construction of the New Palace, it has provided a focal point at the end of the extensive Baroque garden. Court architect Henrico Zuccalli was guided in its design by Italian country villas, known as casino buildings.

The suites reserved for the Electoral couple adjoin the magnificent banqueting hall. On the ceilings, a cycle of frescos of art-historical importance by Francesco Rosa, Giovanni Trubillo and Johann Anton Gumpp exalts Diana, the goddess of the hunt. The rooms are now used as a branch of the Bavarian National Museum, exhibiting a major collection of early Meissen porcelain, established by Prof. Ernst Schneider – the most important such collection after that in Dresden. The palace is flanked by two pavilion buildings designed by Zuccalli: on the south side, the Baroque Renatus Chapel and on the north side, the richly frescoed 'Beautiful Stable'.

*Banqueting Hall (left); idealized view from the east, miniature by Maximilian de Geer, c. 1730 (right)*



**SCHLEISSHEIM PALACE COMPLEX WITH THE NEW PALACE, OLD PALACE AND LUSTHEIM PALACE**

Schloss- und Gartenverwaltung Schleißheim  
 Max-Emanuel-Platz 1 · 85764 Oberschleißheim  
 Tel. +49 89 315872-0  
 www.schloesser-schleissheim.de

**OPENING TIMES OF THE PALACES**

April–September: 9am–6pm  
 October–March: 10am–4pm  
 Closed on Mondays

♿ Lifts/elevators and ramps are available in the New Palace and Old Palace. Access to the museum rooms in Lustheim Palace is via five steps.

**OPENING TIMES OF THE PALACE PARK**

Jan., Feb., Nov., Dec.: 8am–5pm  
 March, October: 8am–6pm  
 April, September: 8am–7pm  
 May–August: 8am–8pm

**REFRESHMENTS**

'Oberschleissheimer Alm' palace restaurant  
 Tel. +49 89 3151555  
 Booking: Tel. +49 89 31288672

**FOUNTAINS**

April–mid-September: daily, 11.30am–4pm;  
 Sat. and Sun., 10am–6pm

**TRANSPORTATION**

Suburban train (S-Bahn) to 'Oberschleissheim',  
 Bus to 'Schloss'  
 Approx. 120 parking spaces

**Closed on 1 January, Shrove Tuesday, and 24, 25 and 31 December**

 Bayerische Verwaltung der staatlichen Schlösser, Gärten und Seen  
 Postfach 20 20 63 · 80020 München  
 www.schloesser.bayern.de

12/2016

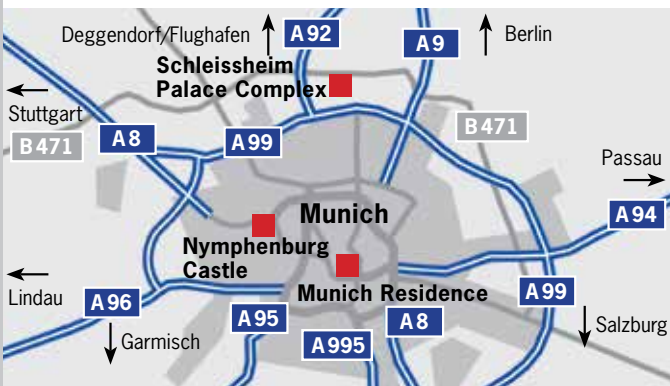

PLAN OF THE PALACE COMPLEX

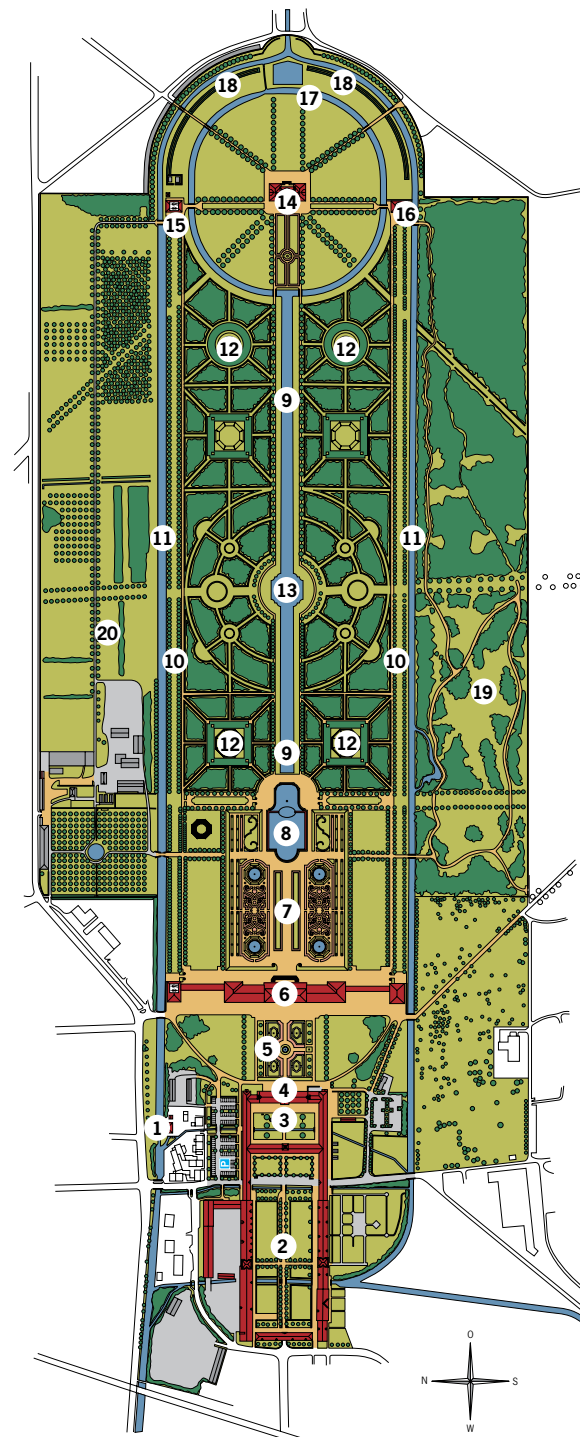

View from Schleissheim New Palace across the parterre, cascade and central canal towards Lustheim Palace

- 1 Fountain station with historical pumps (not accessible)
- 2 Wilhelmshof
- 3 Maximilianshof
- 4 Schleissheim Old Palace
- 5 Parterre between the Old and New Palaces
- 6 Schleissheim New Palace
- 7 Parterre
- 8 Cascade
- 9 Central canal
- 10 Lime avenues
- 11 Side canals
- 12 Bosket area
- 13 Eight-radial double ring at the centre of the bosket area
- 14 Lustheim Palace
- 15 North Pavilion with the 'Beautiful Stable'
- 16 South Pavilion with the Renuatus Chapel
- 17 Perimeter canal around Lustheim Palace
- 18 Hedge enclosure at the site of the former Orangery
- 19 Rural area of the park
- 20 Nursery garden and orchard area (not accessible)

Hercules, Giuseppe Volpini, 1718–1723 (left); New Palace, stucco decoration in the Garden Hall, François Cuvilliés, 1764 (right)



Title page illustration: idealized view of the New Palace with the garden parterre, miniature by Maximilian de Geer, c.1730

# Schleissheim

New Palace  
 Old Palace  
 Lustheim Palace  
 Court Garden



Bayerische Schlösserverwaltung